



Bridgeport Fittings Inc.

705 Lordship Blvd.
Stratford, CT 06615

Phone: 203-377-5944

Fax: 203-381-3488

Large Size Feeder Cable - Two Screw Round Opening - Zinc

Images

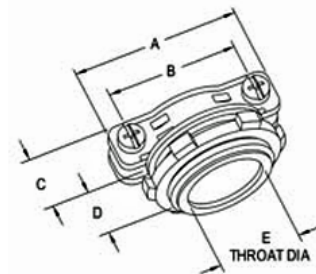

[Download Photo Image](#)

[Download Dimensional Image](#)

Dimension A in Inches: 4.28
Dimension B in Inches: 3.75
Dimension C in Inches: 1.01
Dimension D in Inches: 1.24
Dimension E in Inches: 2.15

Application

Recommended cable types used to connect Armored and Metal Clad cable (4-500 MCM to 4-750 MCM) with 150° Insulated throat to a box or enclosure. Diameter 2.375 - 3

Product Information

Material: Die Cast Zinc

Certifications & Codes:

Federal Specification Number:	A-A-50552
NEMA Standard:	FB-1
UL File Number:	E202876
UL Standard:	UL-514B
UNSPSC:	39121419

Catalog ID: 688-DCI2

UPC Number: 78174716688

Description: 3" Two Screw MC Insulated Connector

Application: Recommended cable types used to connect Armored and Metal Clad cable (4-500 MCM to 4-750 MCM) with 150° Insulated throat to a box or enclosure. Diameter 2.375 - 3

Trade Size: 3"

Country of Manufacture: USA

Std Pkg Qty: 5

Unit Qty: 1