



**Bridgeport Fittings Inc.**

705 Lordship Blvd.  
Stratford, CT 06615

Phone: 203-377-5944

Fax: 203-381-3488

## Large Size Feeder Cable - Two Screw Round Opening - Zinc

### Images

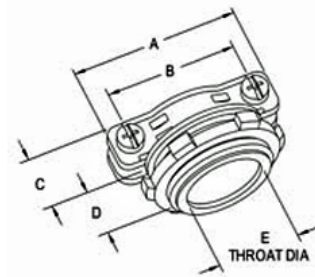

[Download Photo Image](#)

[Download Dimensional Image](#)

Dimension A in Inches: 4.84  
Dimension B in Inches: 4.35  
Dimension C in Inches: 1.1  
Dimension D in Inches: 1.24  
Dimension E in Inches: 2.53

### Application

Recommended cable types used to connect Armored and Metal Clad cable (4-600 MCM to 4-750 MCM) with 150° Insulated Throat to a box or enclosure. Diameter 2.75 - 3.50

### Product Information

Material: Die Cast Zinc

### Certifications & Codes:

Federal Specification Number:	A-A-50552
NEMA Standard:	FB-1
UL File Number:	E202876
UL Standard:	UL-514B
UNSPSC:	39121419

**Catalog ID:** 689-DC12

**UPC Number:** 78174716689

**Description:** 3-1/2" Two Screw MC Insulated Connector

**Application:** Recommended cable types used to connect Armored and Metal Clad cable (4-600 MCM to 4-750 MCM) with 150° Insulated Throat to a box or enclosure. Diameter 2.75 - 3.50

**Trade Size:** 3-1/2"

**Country of Manufacture:** USA

**Std Pkg Qty:** 5

**Unit Qty:** 1