

Type DSL

All Purpose, Extra Flexible Uncovered Conduit
Light Duty/General Electrical Application



Construction

- Constructed of continuously interlocked hot dipped zinc galvanized steel core for exceptional crush and corrosion resistance.
- Extra Flexible continuously interlocked steel construction.



Square Locked Design 3/16" through 3/4"

Installation

- Installs easily with standard armored cable or flexible conduit fittings.
- Exceptional flexibility for tight "U" bend radius.
- Designed to be used for specific applications where agency approvals are not required.
- Special sizes available upon request.
- Available in custom-cut lengths.
- +450°F maximum temperature.



• RoHS WEEE COMPLIANT

Type DSL

Unjacketed flexible steel conduit

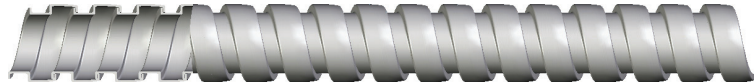

Product Specifications

Ordering Information

Nominal Size Inches		Description Number	Inside Diameter		Outside Diameter		Approx Inside Bend Radius Inches	Standard Length Coil PER	Approx Weight lbs. PER	Part Number NAED
Inches	mm		MIN.	MAX.	MIN.	MAX.				
							100 FT.	100 FT.	PIN	
3/16	5	DSL3	.183	.195	.263	.275	1	250	4.4	460012
1/4	6	DSL4	.245	.260	.335	.350	1	250	5.8	460022
5/16	8	DSL5	.307	.322	.417	.432	1.25	250	6.6	460032
3/8	9	DSL6	.368	.388	.478	.498	1.5	200	8.8	460042
7/16	11	DSL7	.430	.450	.545	.565	1.5	200	10.0	460052
1/2	13	DSL8	.493	.513	.613	.633	1.5	200	11.6	460057
9/16	14	DSL9	.555	.575	.680	.700	1.5	200	13.2	460067
5/8	16	DSL10	.618	.638	.743	.763	2	150	19.1	460072
3/4	19	DSL12	.740	.770	.865	.895	2	150	22.9	460077

TYPICAL SPECIFICATION:

Conduit shall be Anaconda Type DSL. Conduit shall be constructed of continuously interlocked hot dipped zinc galvanized steel and provide a race-way for wiring. Conduit shall be considered all-purpose and be used for general purpose wiring where agency approvals are not required.