



Catalog Number: U4667-Xt-9504
Item Description: 480A CONT/600A MAX 7T OU
UPC Code: 784572240735

Brand Name: Milbank
Type: Bolt On Meter Socket
Application: Meter Socket
Standard: UL Listed
Voltage Rating: 600 Volts Alternating Current
Amperage Rating: 480 Continuous Ampere
Phase: 3 Phase
Frequency Rating: 60 Hertz
Number Of Cutouts: 0
Cable Entry: Overhead and Underground
Terminal: 1/2 Inch Stud Line Side and 1/2 Inch Stud Load Side
Mounting: Surface Mount
Enclosure: Type 3R, G90 Galvanized Steel with Powder Coat Finish

Additional Specifications: Number of Jaws:7 Terminal
Hub Opening and Closing Plates:Twin Large Closing Plates
Hub Opening and Closing Plates:Twin Large Closing Plates
Hub Opening and Closing Plates:Twin Large Closing Plates
Hub Opening and Closing Plates:Twin Large Closing Plates
Hub Opening and Closing Plates:Twin Large Closing Plates



Utility requirements may vary. Always consult the serving utility for their requirements prior to ordering or installing this equipment. This product must always be installed by a licensed electrician. Installation of this equipment may require local electrical inspector approval.

FEATURE TABLE		
ITEM	QTY	DESCRIPTION
A	2	TRANS. MNTG.EMBOSS
B	4	U/L MNTG.EMBOSS
C	1	¼ SOLID K.O.
D	2	½, ¾ CONC. K.O.
E	7	3, 3½, 4 CONC. K.O.

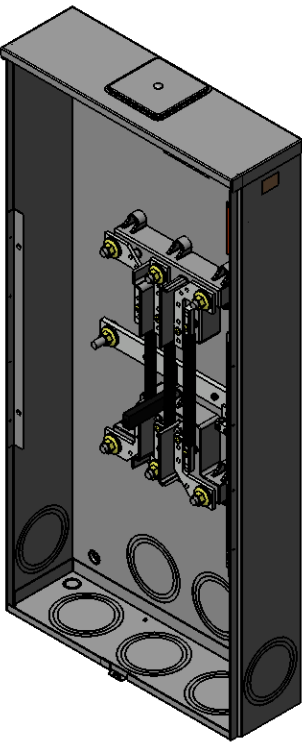
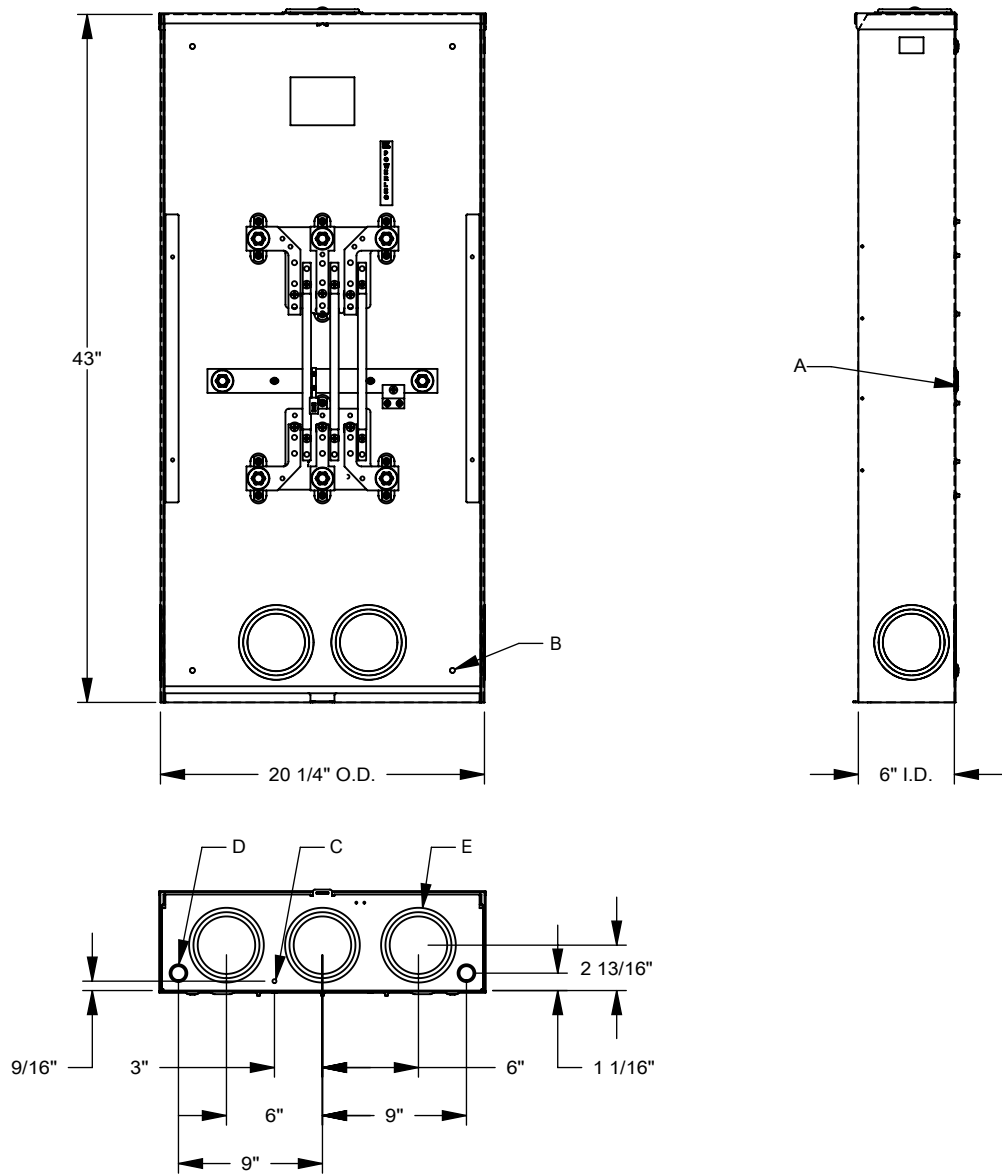

Version:

1

All dimensions are +/- 1/16".
Drawing views are not to scale.
Utility requirements for this equipment may vary. Always consult the serving utility for their requirements prior to ordering or installing this equipment. This product must be installed by a licensed electrician. Installation of this equipment may require local electrical inspector approval.