

Product data sheet

Specifications



Remote graphic display with buttons - 128 x 64 pixels for M168 base controller

TM168GDB

 **Discontinued on:** Sep 27, 2024

 **Discontinued**

**Product availability: Non-Stock - Not normally stocked in
distribution facility**

Main

Range of Product	Modicon M168 logic controller
Product or Component Type	Graphic display
Power Consumption in W	5 W
Display Type	LCD
Display colour	Monochrome
Display Resolution	128 x 64 pixels
[Us] rated supply voltage	24 V AC/DC non isolated
Number of key	6
Supply	External source

Complementary

Standards	UL 60730-1 CSA 60730-1 EN 61000-6-1 EN 60730-1 EN 61000-6-3
Marking	CE
Realtime clock	With <= 30 s/month 2 days
Local signalling	1 LED (green) for power supply 1 LED (red) for bus activity RX (reception) 1 LED (red) for bus activity TX (transmission)
Memory type	Internal
Backup Time	10 years
Number of read/write cycles	1000000
Supply voltage limits	18...30 V
Immunity to microbreaks	10 ms
Height	5.2 in (133 mm)
Width	4.4 in (112 mm)
Depth	1.4 in (36 mm)
Net Weight	0.53 lb(US) (0.24 kg)

Environment

Ambient Air Temperature for Operation	32...131 °F (0...55 °C)
--	-------------------------

Price is "List Price" and may be subject to a trade discount – check with your local distributor or retailer for actual price.

Disclaimer: This documentation is not intended as a substitute for and is not to be used for determining suitability or reliability of these products for specific user applications

Ambient Air Temperature for Storage	-4...158 °F (-20...70 °C)
IP degree of protection	IP40 front face:
Pollution degree	2
Overvoltage category	III
Vibration resistance	3.5 mm (f= 5...8.4 Hz) conforming to EN/IEC 60028-2-6 1 gn (f= 8.4...150 Hz) conforming to EN/IEC 60028-2-6
Shock resistance	15 gn 11 ms

Ordering and shipping details

Category	US1PC1222535
Discount Schedule	PC12
GTIN	3595864109657
Returnability	No

Packing Units

Unit Type of Package 1	PCE
Number of Units in Package 1	1
Package 1 Height	1.97 in (5.0 cm)
Package 1 Width	4.92 in (12.5 cm)
Package 1 Length	5.91 in (15.0 cm)
Package 1 Weight	8.6 oz (245.0 g)

Contractual warranty

Warranty	18 months
----------	-----------

Dimensions Drawings

Graphical Remote Displays

Dimensions

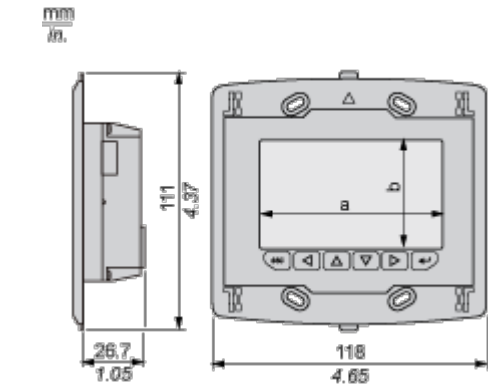

	TM168GDB	TM168GDTS
a	58 mm/2.28 in.	81.5 mm/3.21 in.
b	30 mm/1.18 in.	48.5 mm/1.91 in.

Front frame (included)

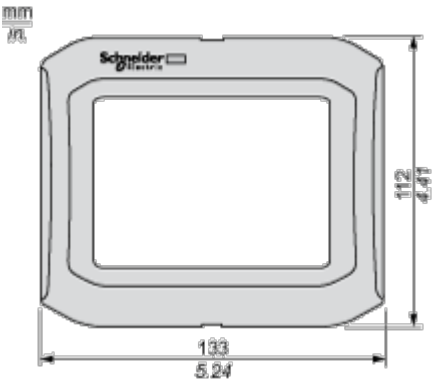

Mounting and Clearance

Graphical Remote Displays

Panel Cut-out

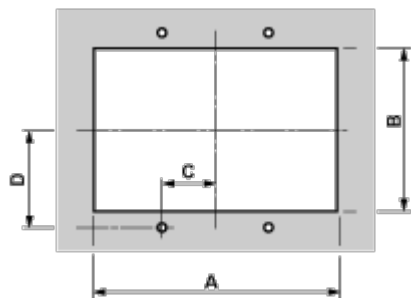

TM168GDB/ TM168GDTs	Minimum	Typical	Maximum
A	104 mm/4.09 in.	104 mm/4.09 in.	104.8 mm/4.13 in.
B	70 mm/2.76 in.	70 mm/2.76 in.	70.8 mm/2.79 in.
C	22 mm/0.87 in.	23 mm/2.28 in.	24 mm/0.94 in.
D	40.8 mm/1.61 in.	41.8 mm/1.65 in.	42.8 mm/1.69 in.

Installation

Several types of installation are offered:

- panel mounting
- built-in mounting
- wall mounting, with the support TM168AGD1 (order separately)

Example: panel mounting with 4 screws (not included).

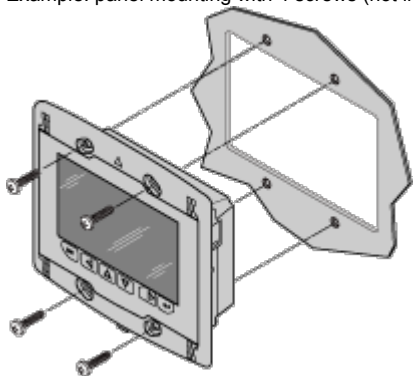

A front frame can be applied to the front of the device (included).

Connections and Schema

Graphical Remote Displays

Wiring Diagram

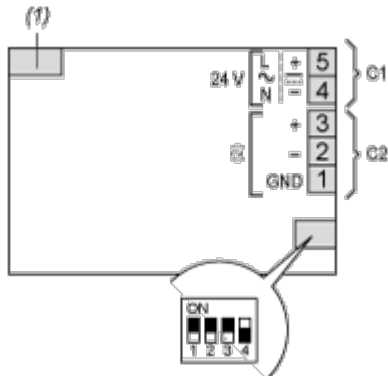

- (1) Programming port
- (2) Expansion
- C1 Connector 1
- C2 Connector 2

If the device is at the end of the expansion bus, position the micro-switch 4 to ON. Micro-switches 1, 2 and 3 are reserved.

Connector 1: power supply

PIN	MEANING
4	power supply
5	power supply

Connector 2: expansion bus

PIN	MEANING
1	common (GND)
2	signal -
3	signal +

Wiring Requirements

- Solid wires 0.05...1.5 mm² (30...16 AWG)
- Stranded wires 0.05...1.0 mm² (30...17 AWG)
- Stripping length 5...6 mm (0.20...0.24 in.)
- Tightening torque 0.2...0.25 Nm (1.77...1.21 lb-in)