

# LevNet RF™ 902MHz Self-Powered Wireless Solutions

## Wireless Remote Switches

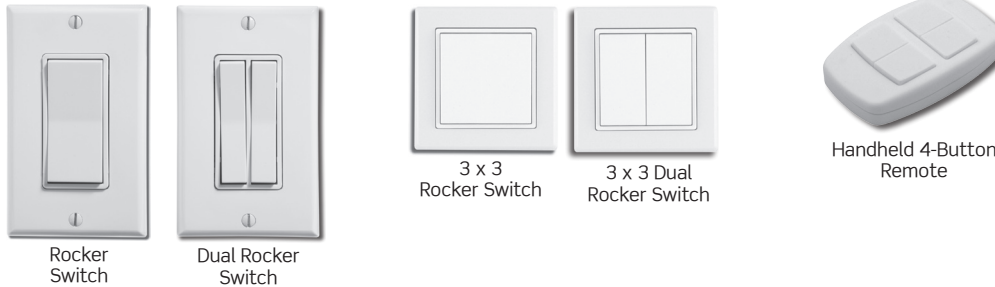

**Self-Powered Wireless technology means no wiring is required.** Leviton LevNet RF™ Self-Powered Wireless Solutions are easy to install and maintenance-free, utilizing no batteries and free to operate, saving ongoing labor and material costs while saving energy.

LevNet RF devices offer zero power consumption and zero maintenance for recurring savings for the building owner. EnOcean® technology allows energy harvesting LevNet RF Transmitters to operate indefinitely without the use of batteries. The human motion of a switch actuation, light on a solar cell, or temperature differentials in the environment provide power to LevNet RF Transmitters, eliminating additional expenses to the end user's energy bill and allowing zero maintenance wireless devices. The LevNet RF 902MHz line includes multiple products that operate in the uncrowded 902MHz band offering greater transmission range (50-150 feet) than other wireless technologies and minimal competitive traffic.



**LevNet RF 902MHz Wireless Remote Switches** can control an unlimited number of LevNet 902MHz RF Receivers that are in range. LevNet RF Remote Switches use no wires or batteries resulting in zero power consumption and no energy used. Pressing the switch provides the energy to transmit a wireless signal that controls lights or other devices connected to LevNet RF Receivers. Wireless Switches are primarily used to control lights in businesses or homes, but they can be used to control virtually any on/off device.

Each Self-Powered Wireless Remote Switch can be placed anywhere within range of a Receiver. Traditionally the Remote Switch is surface mounted on a wall with screws or industrial tape, but can also be used in a standard switch box or as a wireless handheld remote. The unique ID of each Switch activates only the intended Receiver(s). Wireless, self-powered technologies make them the ideal solution for retrofits and new construction. Installation is quick and easy with no additional wiring required. It takes only minutes to install and configure.

### APPLICATIONS

- Retrofits
- Conference rooms
- Lounges/Lobbies
- Executive offices
- Daycare facilities
- Multi-location (3-way or 4-way) switching applications
- New construction
- Classrooms
- Private offices
- Restrooms
- Multimedia areas

**Leviton Mfg. Co., Inc. Lighting & Energy Solutions**

201 N. Service Rd. Melville, NY 11747-3138 Tech Line: 1-800-824-3005 Fax: 1-800-832-9538 www.leviton.com/les  
© 2014 Leviton Manufacturing Co., Inc. All rights reserved. Subject to change without notice.

## PRODUCT DATA

### SINGLE ROCKER DECORA® SWITCH (WSS0S-S9)

### DUAL ROCKER DECORA SWITCH (WSS0S-D9)

### 3 X 3 SINGLE ROCKER SWITCH (WSS0S-E9)

### 3 X 3 DUAL ROCKER SWITCH (WSS0S-F9)



Control one light or one group of lights with the Wireless Self-Powered Single Rocker Switch. One switch can control an unlimited number of LevNet RF Receivers that are within range.

Control two lights or two groups of lights with the Wireless Self-Powered Dual Rocker Switch. Each rocker can separately control an unlimited number of LevNet RF Receivers that are within range.

### HANDHELD 4-BUTTON REMOTE (WSS0S-R9)

Control two lights, two groups, or four individual lights with the Handheld Remote. Each button can separately control an unlimited number of LevNet RF Receivers that are within range.



The Remote has four buttons - programmable to control up to four individual Receivers or dependent groups. Small enough to fit in the palm of your hand, you can also keep it in your pocket, on a table, or leave it in your car to turn lights on as you pull up to a building or house.

Ideal for energy-saving hotel room controls - occupancy-based control of lights and devices, integrated HVAC and lighting control, and optional master ON/OFF controls.

### FEATURES

- **Zero Power Consumption:** the motion of a switch actuation provides the energy to power the device, eliminating additional expenses to the end user's energy bill
- **Zero External Power Required:** with no power wire limitations, this offers the installer flexibility to place the RF switch anywhere
- **Zero Charge Time to Operation:** self-powered technology enables the RF device to be operational immediately
- **True Wireless:** RF switches are self-powered and communicates with all LevNet RF and EnOcean Receivers via radio frequency
- **No Additional Wiring:** self-powered wireless technology eliminates the need to pull additional wire making installation quick and easy and increasing labor savings with little to no impact to business during conversion

- **No Batteries or External Power Required:** exclusive "battery-less" technology significantly reduces callbacks and maintenance for additional savings
- **Additional Energy Savings:** wireless technology supports simplified daylight harvesting and manual override options with no additional wiring
- **Rocker style ON/OFF switching:** provides remote control for manual-ON/OFF light switching of each multiple light load at any time; top button = ON, bottom button = OFF (WSS0S-S9, WSS0S-D9, WSS0S-E9, and WSS0S-F9)
- **Momentary style ON/OFF Switching:** provides remote control for pushbutton manual-ON/OFF light switching of each multiple light load at any time; hold button=ON, release button = OFF
- **Convenient multi-location (3-way or 4-way) switching:** mount Switches anywhere, create 3-way or 4-way switches, control lights, motors, or other electrical loads, and reconfigure or relocate as needed
- **Save energy:** create manual-ON/auto-OFF controls using LevNet RF Switches and occupancy sensors or by programming all lights to respond to a single master switch
- **Control the way you want it:** use with multiple line voltage or low voltage LevNet RF Receivers, control an unlimited number of LevNet RF Receivers within range for wireless dimming or ON/OFF control

**NETWORK DIAGRAMS**

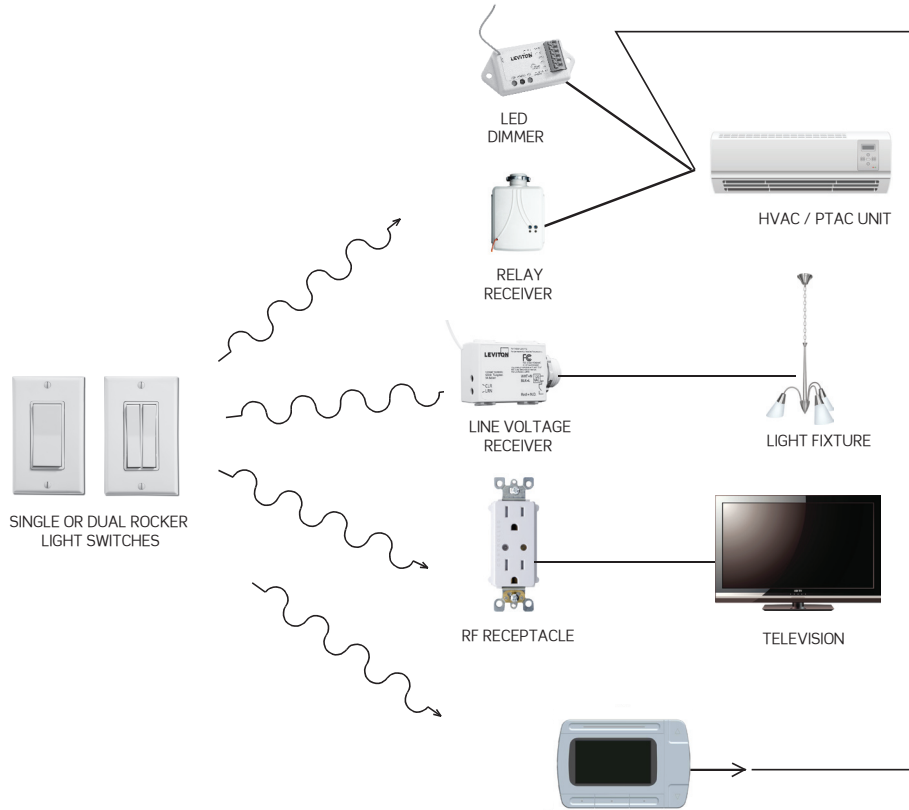

**DIMENSIONS**

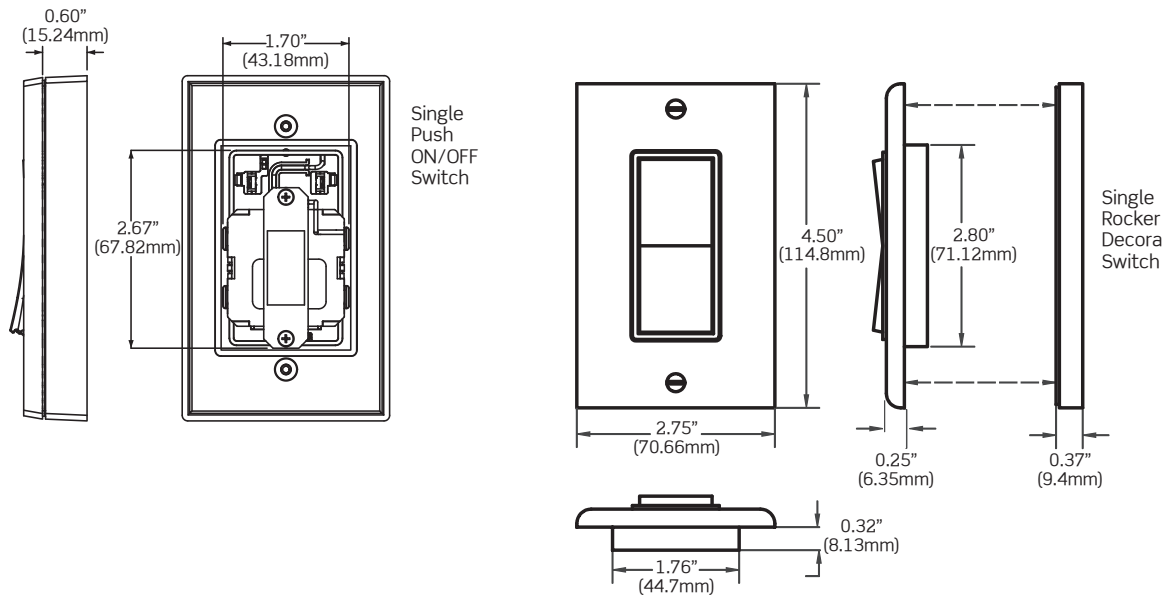

**Leviton Mfg. Co., Inc. Lighting Lighting & Energy Solutions**

201 N. Service Rd. Melville, NY 11747-3138 Tech Line: 1-800-824-3005 Fax: 1-800-832-9538 www.leviton.com/les  
 © 2014 Leviton Manufacturing Co., Inc. All rights reserved. Subject to change without notice.

# PRODUCT DATA



## SPECIFICATIONS

LEVNET RF REMOTE SWITCHES	
Frequency	902MHz
Range	50-150'
Transmission interval	Human touch
Transmission time	>30 Milliseconds
Transmissions	2 packets per press or release
Mechanical Cycles	>50,000
Device Address	Unique from factory
Power Supply	Self-generated when switch is pressed or Key Card is inserted into the switch
Output Channels	Only limited by number of Receivers in range
Usage	Indoors only
Operating Temperature Range	32°F to 104°F (0°C to 40°C)
Radio Certification	FCC Certified for Wireless Communication (U.S.), I.C. Certified (Canada)
Warranty	Limited Five-Year
SINGLE ROCKER DECORA SWITCH (WSS0S-S9) DUAL ROCKER DECORA SWITCH (WSS0S-D9)	
Rockers	WSS0S-D9: 1 Rocker, 2 pushbuttons WSS0S-D9: 2 Rockers, 4 pushbuttons
Dimensions	2.75" W x 4.5" H x 0.62" D (69.85mm x 114.30mm x 15.75mm)
3 X 3 SINGLE ROCKER SWITCH (WSS0S-E9) 3 X 3 DUAL ROCKER SWITCH (WSS0S-F9)	
Rockers	WSS0S-E9: 1 Rocker, 2 pushbuttons WSS0S-F9: 2 Rockers, 4 pushbuttons
Dimensions	3.39" W x 3.29" H x 0.41" D (86.11mm x 83.57mm x 10.41mm)
HANDHELD 4-BUTTON REMOTE (WSS0S-R9)	
Pushbutton	4 Individual pushbuttons
Dimensions	1.85" W x 3.15" H x 0.7" D (46.99mm x 80.01mm x 17.78mm)

## ORDERING INFORMATION

CAT NO.	DESCRIPTION
WSS0S-S9*	1-Gang Single Rocker Decora Switch
WSS0S-D9*	1-Gang Dual Rocker Decora Switch
WSS0S-E9*	3 x 3 Single Rocker Switch
WSS0S-F9*	3 x 3 Dual Rocker Switch
WSS0S-R9	Handheld 4-Button Remote, White

\*To indicate color, add suffix to the end of the catalog number. Available in White (-W), Ivory (-I), Light Almond (-T), Gray (-G), and Ebony (-E).

NAFTA and Made in USA models available.

LevNet RF™ 902MHz Wireless Remote Switches

### Leviton Manufacturing Co., Inc. Global Headquarters

201 N. Service Rd. Melville, NY 11747-3138 Tech Line: 1-800-824-3005 Fax: 1-800-832-9538

### Leviton Manufacturing Co., Inc. Lighting & Energy Solutions

20497 SW Teton Avenue, Tualatin, OR 97062 Tel: 1-800-736-6682 • Tech Line: 1-800-959-6004 (6:00-4:00 Monday-Friday) • Fax: 503-404-5594

### Leviton Manufacturing of Canada, Ltd.

165 Hymus Boulevard, Pointe Claire, Quebec H9R 1E9 • Telephone: 1-800-469-7890 • FAX: 1-800-563-1853

### Leviton S. de R.L. de C.V.

Lago Tana 43, Mexico DF, Mexico CP 11290 • Tel. (+52) 55-5082-1040 • FAX: (+52) 5386-1797 • www.leviton.com.mx

### Visit our Website at: [www.leviton.com/les](http://www.leviton.com/les)

© 2014 Leviton Manufacturing Co., Inc. All rights reserved. Subject to change without notice.

G-9215/J14-aa