

THIS COPY IS PROVIDED ON A RESTRICTED BASIS AND IS NOT TO BE USED IN ANY WAY DETRIMENTAL TO THE INTERESTS OF PANDUIT CORP.

PANDUIT P/N	WEIGHT
P36D26M-XYZ	SEE SHEET 2

**SPECIFICATION:**

1. STANDARD:  
 UNIT TYPE: MONITORED INPUT  
 ORIENTATION: VERTICAL, 0U FULL  
 OUTLET QTY & TYPE: (30) C13, (6) C19  
 INPUT VOLTAGE: 200-240VAC  
 INPUT CURRENT: 50A (40A DERATED)  
 BREAKER QTY & TYPE: (3) 20AMP, DOUBLE-POLE  
 INPUT PHASE: SINGLE-PHASE  
 RATED POWER: 8.3 kVA  
 INPUT PLUG: CS8265C  
 INPUT POWER CORD: SEE SHEET 2 FOR PART NUMBER TABLE  
 REGULATORY STANDARD: RoHS COMPLIANT

2. ADDITIONAL:  
 NONE

3. ACCESSORIES:  
 (1) QUICK-START GUIDE

**NOTES:**

- PRIMARY DIMENSIONS ARE IN MILLIMETERS. SECONDARY DIMENSION ARE IN [ INCHES ]
- INSTALLATION SHALL COMPLY WITH ALL APPLICABLE NATIONAL, STATE, AND LOCAL CODES
- VISIT OUR ON-LINE CATALOG AT WWW.PANDUIT.COM FOR A CURRENT LIST OF PRODUCTS APPLICABLE FOR USE WITH THIS PART
- FOR FULL PRODUCT FUNCTIONALITY REFER TO USER MANUAL
- DRAWING VIEWS SHOW THE INPUT CORD IN THE "TOP END FED" CONFIGURATION

**IDENTIFICATION**  
 FOR FINISHED GOOD PART NUMBER & DESCRIPTION TABLE SEE SHEET 2 CONFIGURABLE PART NUMBERS: P36D26M-XX Y Z

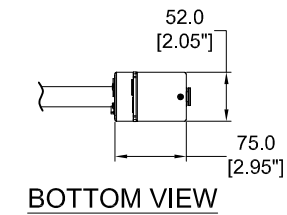
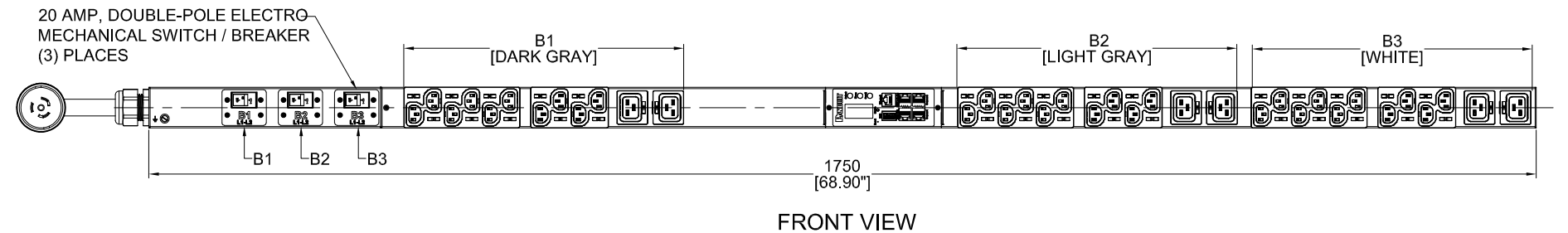
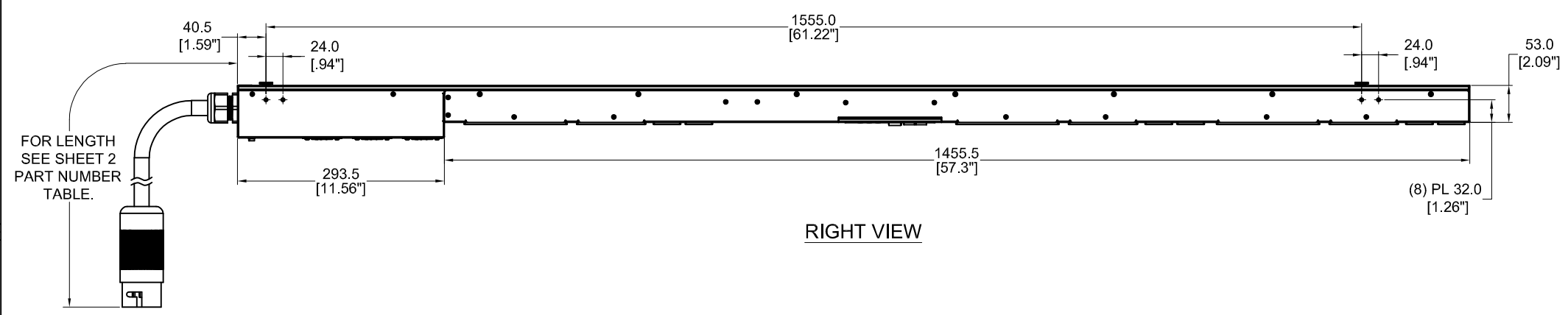
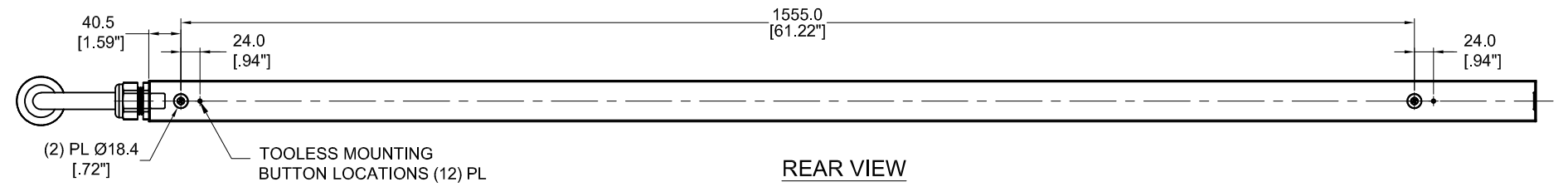
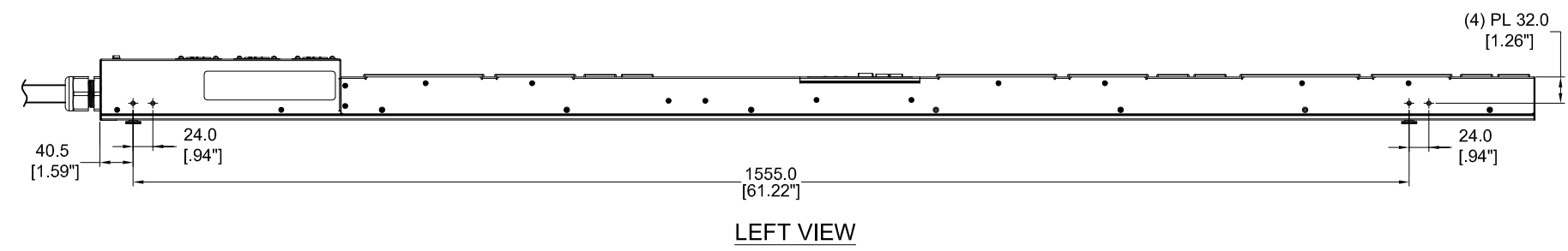

XX: FINISHED GOOD COLOR BL=BLACK YL=YELLOW RD=RED BU=BLUE WH=WHITE GN=GREEN	Y: INPUT FEED TYPE 1=TOP-END FED 2=BOTTOM-END FED	Z: INPUT CORD LENGTH A=1 METER B=2 METER C=3 METER
--	---	---

**PLUG/RECEPTACLE BLOCK**

	PLUG CS8265C, 3P 4W 50A, 250V MAX RATED INPUT 40A DERATED
	RECEPTACLES IEC 60320/C19 16A, 250V MAX RATED OUTPUT
	RECEPTACLES IEC 60320/C13 10A, 250V MAX RATED OUTPUT

REV	DATE	BY	CHK	APR	DESCRIPTION	ECN
02A	06/07/2018	H.XU	MIM	JAWI	ADDED SHEET 2 WITH CONFIGURABLE PART NUMBER TABLE AND DESCRIPTION UPDATED IDENTIFICATION TO INCLUDE CONFIGURABLE OPTION DE-CODER UPDATED CIRCUIT BREAKER LABELS WITH ROTATED TEXT	P36D26M
01A	08/02/2017	WSJ	MIM	EDM	INITIAL RELEASE	P36D26M

WE ASK THAT YOU CHECK FULLY THE DIMENSIONS, NOTES, AND SIGN THE CLIENT SIGNATURE BOX. THE JOB WILL NOT PROGRESS WITHOUT SIGNED APPROVAL. PLEASE DO NOT DELAY IN RETURNING PROOF AS IT WILL AFFECT DELIVERY

SIGN \_\_\_\_\_  
 DATE \_\_\_\_\_  
 PRINT \_\_\_\_\_

TITLE: INTELLIGENT SERIES PDU  
 P36D26M-XYZ  
 CUSTOMER DRAWING

ITEM REVISION NAME: \_\_\_\_\_  
 DATASHEET FILE NAME: \_\_\_\_\_

UNLESS OTHERWISE SPECIFIED  
 DIMENSIONAL TOLERANCE ARE: mm [IN]

Tolerance(mm)	
0-4<50	±0.5
50-4<250	±1.0
250-4<500	±1.5
500-4<1000	±2.5
1000-4<2000	±4.0

THIRD ANGLE PROJECTION

MATERIAL/COLOR: N/A

DRAWING NUMBER: P36D26M\_DC

DRAWN BY: WSJ DATE: 08/02/2017 CHK: SEAN SCALE: NONE

SHT 1 OF 2 SCALE: B

2



1

THIS COPY IS PROVIDED ON A RESTRICTED BASIS AND IS NOT TO BE USED IN ANY WAY DETRIMENTAL TO THE INTERESTS OF PANDUIT CORP.

FINISHED GOOD PART NUMBER	FINISHED GOOD DESCRIPTION	COLOR	INPUT CORD LENGTH	WEIGHT
P36D26M	VERTICAL,(30) C13,(6) C19,MONITORED INPUT, 200-240V/50A/1 PHASE , TOP-END FED, 3 METER INPUT CORD, BLACK	BLACK (RAL 9005)	3M(+254MM-127MM) 10'[+10''-5"]	9.9kg
P36D26M-BL1A	VERTICAL,(30) C13,(6) C19,MONITORED INPUT, 200-240V/50A/1 PHASE , TOP-END FED, 1 METER INPUT CORD, BLACK	BLACK (RAL 9005)	1M(+178MM-89MM) 3.3'[+3.5''-1.75"]	8.5kg
P36D26M-BL1B	VERTICAL,(30) C13,(6) C19,MONITORED INPUT, 200-240V/50A/1 PHASE , TOP-END FED, 2 METER INPUT CORD, BLACK	BLACK (RAL 9005)	2M(+178MM-89MM) 6.5'[+7''-3.5"]	9.2kg
P36D26M-RD1A	VERTICAL,(30) C13,(6) C19,MONITORED INPUT, 200-240V/50A/1 PHASE , TOP-END FED, 1 METER INPUT CORD, RED	RED (RAL 3020)	1M(+178MM-89MM) 3.3'[+3.5''-1.75"]	8.5kg
P36D26M-RD1B	VERTICAL,(30) C13,(6) C19,MONITORED INPUT, 200-240V/50A/1 PHASE , TOP-END FED, 2 METER INPUT CORD, RED	RED (RAL 3020)	2M(+178MM-89MM) 6.5'[+7''-3.5"]	9.2kg
P36D26M-RD1C	VERTICAL,(30) C13,(6) C19,MONITORED INPUT, 200-240V/50A/1 PHASE , TOP-END FED, 3 METER INPUT CORD, RED	RED (RAL 3020)	3M(+254MM-127MM) 10'[+10''-5"]	9.9kg
P36D26M-WH1A	VERTICAL,(30) C13,(6) C19,MONITORED INPUT, 200-240V/50A/1 PHASE , TOP-END FED, 1 METER INPUT CORD, WHITE	WHITE (RAL 9003)	1M(+178MM-89MM) 3.3'[+3.5''-1.75"]	8.5kg
P36D26M-WH1B	VERTICAL,(30) C13,(6) C19,MONITORED INPUT, 200-240V/50A/1 PHASE , TOP-END FED, 2 METER INPUT CORD, WHITE	WHITE (RAL 9003)	2M(+178MM-89MM) 6.5'[+7''-3.5"]	9.2kg
P36D26M-WH1C	VERTICAL,(30) C13,(6) C19,MONITORED INPUT, 200-240V/50A/1 PHASE , TOP-END FED, 3 METER INPUT CORD, WHITE	WHITE (RAL 9003)	3M(+254MM-127MM) 10'[+10''-5"]	9.9kg
P36D26M-YL1A	VERTICAL,(30) C13,(6) C19,MONITORED INPUT, 200-240V/50A/1 PHASE , TOP-END FED, 1 METER INPUT CORD, YELLOW	YELLOW (RAL 1023)	1M(+178MM-89MM) 3.3'[+3.5''-1.75"]	8.5kg
P36D26M-YL1B	VERTICAL,(30) C13,(6) C19,MONITORED INPUT, 200-240V/50A/1 PHASE , TOP-END FED, 2 METER INPUT CORD, YELLOW	YELLOW (RAL 1023)	2M(+178MM-89MM) 6.5'[+7''-3.5"]	9.2kg
P36D26M-YL1C	VERTICAL,(30) C13,(6) C19,MONITORED INPUT, 200-240V/50A/1 PHASE , TOP-END FED, 3 METER INPUT CORD, YELLOW	YELLOW (RAL 1023)	3M(+254MM-127MM) 10'[+10''-5"]	9.9kg
P36D26M-BU1A	VERTICAL,(30) C13,(6) C19,MONITORED INPUT, 200-240V/50A/1 PHASE , TOP-END FED, 1 METER INPUT CORD, BLUE	BLUE (RAL 5005)	1M(+178MM-89MM) 3.3'[+3.5''-1.75"]	8.5kg
P36D26M-BU1B	VERTICAL,(30) C13,(6) C19,MONITORED INPUT, 200-240V/50A/1 PHASE , TOP-END FED, 2 METER INPUT CORD, BLUE	BLUE (RAL 5005)	2M(+178MM-89MM) 6.5'[+7''-3.5"]	9.2kg
P36D26M-BU1C	VERTICAL,(30) C13,(6) C19,MONITORED INPUT, 200-240V/50A/1 PHASE , TOP-END FED, 3 METER INPUT CORD, BLUE	BLUE (RAL 5005)	3M(+254MM-127MM) 10'[+10''-5"]	9.9kg
P36D26M-GN1A	VERTICAL,(30) C13,(6) C19,MONITORED INPUT, 200-240V/50A/1 PHASE , TOP-END FED, 1 METER INPUT CORD, GREEN	GREEN (RAL 6001)	1M(+178MM-89MM) 3.3'[+3.5''-1.75"]	8.5kg
P36D26M-GN1B	VERTICAL,(30) C13,(6) C19,MONITORED INPUT, 200-240V/50A/1 PHASE , TOP-END FED, 2 METER INPUT CORD, GREEN	GREEN (RAL 6001)	2M(+178MM-89MM) 6.5'[+7''-3.5"]	9.2kg
P36D26M-GN1C	VERTICAL,(30) C13,(6) C19,MONITORED INPUT, 200-240V/50A/1 PHASE , TOP-END FED, 3 METER INPUT CORD, GREEN	GREEN (RAL 6001)	3M(+254MM-127MM) 10'[+10''-5"]	9.9kg
P36D26M-BL2A	VERTICAL,(30) C13,(6) C19,MONITORED INPUT, 200-240V/50A/1 PHASE , BOTTOM-END FED, 1 METER INPUT CORD, BLACK	BLACK (RAL 9005)	1M(+178MM-89MM) 3.3'[+3.5''-1.75"]	8.5kg
P36D26M-BL2B	VERTICAL,(30) C13,(6) C19,MONITORED INPUT, 200-240V/50A/1 PHASE , BOTTOM-END FED, 2 METER INPUT CORD, BLACK	BLACK (RAL 9005)	2M(+178MM-89MM) 6.5'[+7''-3.5"]	9.2kg
P36D26M-BL2C	VERTICAL,(30) C13,(6) C19,MONITORED INPUT, 200-240V/50A/1 PHASE , BOTTOM-END FED, 3 METER INPUT CORD, BLACK	BLACK (RAL 9005)	3M(+254MM-127MM) 10'[+10''-5"]	9.9kg
P36D26M-RD2A	VERTICAL,(30) C13,(6) C19,MONITORED INPUT, 200-240V/50A/1 PHASE , BOTTOM-END FED, 1 METER INPUT CORD, RED	RED (RAL 3020)	1M(+178MM-89MM) 3.3'[+3.5''-1.75"]	8.5kg
P36D26M-RD2B	VERTICAL,(30) C13,(6) C19,MONITORED INPUT, 200-240V/50A/1 PHASE , BOTTOM-END FED, 2 METER INPUT CORD, RED	RED (RAL 3020)	2M(+178MM-89MM) 6.5'[+7''-3.5"]	9.2kg
P36D26M-RD2C	VERTICAL,(30) C13,(6) C19,MONITORED INPUT, 200-240V/50A/1 PHASE , BOTTOM-END FED, 3 METER INPUT CORD, RED	RED (RAL 3020)	3M(+254MM-127MM) 10'[+10''-5"]	9.9kg
P36D26M-WH2A	VERTICAL,(30) C13,(6) C19,MONITORED INPUT, 200-240V/50A/1 PHASE , BOTTOM-END FED, 1 METER INPUT CORD, WHITE	WHITE (RAL 9003)	1M(+178MM-89MM) 3.3'[+3.5''-1.75"]	8.5kg
P36D26M-WH2B	VERTICAL,(30) C13,(6) C19,MONITORED INPUT, 200-240V/50A/1 PHASE , BOTTOM-END FED, 2 METER INPUT CORD, WHITE	WHITE (RAL 9003)	2M(+178MM-89MM) 6.5'[+7''-3.5"]	9.2kg
P36D26M-WH2C	VERTICAL,(30) C13,(6) C19,MONITORED INPUT, 200-240V/50A/1 PHASE , BOTTOM-END FED, 3 METER INPUT CORD, WHITE	WHITE (RAL 9003)	3M(+254MM-127MM) 10'[+10''-5"]	9.9kg
P36D26M-YL2A	VERTICAL,(30) C13,(6) C19,MONITORED INPUT, 200-240V/50A/1 PHASE , BOTTOM-END FED, 1 METER INPUT CORD, YELLOW	YELLOW (RAL 1023)	1M(+178MM-89MM) 3.3'[+3.5''-1.75"]	8.5kg
P36D26M-YL2B	VERTICAL,(30) C13,(6) C19,MONITORED INPUT, 200-240V/50A/1 PHASE , BOTTOM-END FED, 2 METER INPUT CORD, YELLOW	YELLOW (RAL 1023)	2M(+178MM-89MM) 6.5'[+7''-3.5"]	9.2kg
P36D26M-YL2C	VERTICAL,(30) C13,(6) C19,MONITORED INPUT, 200-240V/50A/1 PHASE , BOTTOM-END FED, 3 METER INPUT CORD, YELLOW	YELLOW (RAL 1023)	3M(+254MM-127MM) 10'[+10''-5"]	9.9kg
P36D26M-BU2A	VERTICAL,(30) C13,(6) C19,MONITORED INPUT, 200-240V/50A/1 PHASE , BOTTOM-END FED, 1 METER INPUT CORD, BLUE	BLUE (RAL 5005)	1M(+178MM-89MM) 3.3'[+3.5''-1.75"]	8.5kg
P36D26M-BU2B	VERTICAL,(30) C13,(6) C19,MONITORED INPUT, 200-240V/50A/1 PHASE , BOTTOM-END FED, 2 METER INPUT CORD, BLUE	BLUE (RAL 5005)	2M(+178MM-89MM) 6.5'[+7''-3.5"]	9.2kg
P36D26M-BU2C	VERTICAL,(30) C13,(6) C19,MONITORED INPUT, 200-240V/50A/1 PHASE , BOTTOM-END FED, 3 METER INPUT CORD, BLUE	BLUE (RAL 5005)	3M(+254MM-127MM) 10'[+10''-5"]	9.9kg
P36D26M-GN2A	VERTICAL,(30) C13,(6) C19,MONITORED INPUT, 200-240V/50A/1 PHASE , BOTTOM-END FED, 1 METER INPUT CORD, GREEN	GREEN (RAL 6001)	1M(+178MM-89MM) 3.3'[+3.5''-1.75"]	8.5kg
P36D26M-GN2B	VERTICAL,(30) C13,(6) C19,MONITORED INPUT, 200-240V/50A/1 PHASE , BOTTOM-END FED, 2 METER INPUT CORD, GREEN	GREEN (RAL 6001)	2M(+178MM-89MM) 6.5'[+7''-3.5"]	9.2kg
P36D26M-GN2C	VERTICAL,(30) C13,(6) C19,MONITORED INPUT, 200-240V/50A/1 PHASE , BOTTOM-END FED, 3 METER INPUT CORD, GREEN	GREEN (RAL 6001)	3M(+254MM-127MM) 10'[+10''-5"]	9.9kg

B

B



A

A

WE ASK THAT YOU CHECK FULLY THE DIMENSIONS, NOTES, AND SIGN THE CLIENT SIGNATURE BOX. THE JOB WILL NOT PROGRESS WITHOUT SIGNED APPROVAL. PLEASE DO NOT DELAY IN RETURNING PROOF AS IT WILL AFFECT DELIVERY		SIGN
		DATE
		PRINT
TITLE INTELLIGENT SERIES PDU P36D26M-XXYZ CUSTOMER DRAWING		
ITEM REVISION NAME		
DATASHEET FILE NAME:		
UNLESS OTHERWISE SPECIFIED DIMENSIONAL TOLERANCE ARE: mm [IN]		MATERIAL/COLOR: N/A
Tolerance(mm) 0-4<50 ±0.5 50-4<250 ±1.0 250-4<500 ±1.5 500-4<1000 ±2.5 1000-4<2000 ±4.0		DRAWING NUMBER: P36D26M_DC
THIRD ANGLE PROJECTION	DRAWN BY: WSJ	DATE: 08/02/2017
	CHK: SEAN	SCALE: NONE
		SHT 2 OF 2
		SCALE: B

REV	DATE	BY	CHK	APR	DESCRIPTION	ECN
02A	06/07/2018	H.XU	MIM	JAWI	ADDED SHEET 2 WITH CONFIGURABLE PART NUMBER TABLE AND DESCRIPTION UPDATED IDENTIFICATION TO INCLUDE CONFIGURABLE OPTION DE-CODER UPDATED CIRCUIT BREAKER LABELS WITH ROTATED TEXT	P36D26M
01A	08/02/2017	WSJ	MIM	EDM	INITIAL RELEASE	P36D26M

2



1