

PVC COATED CONDUIT BODIES - LR FORM 8

Features:

- Exterior PVC coating thickness is a minimum 0.040"
- Interior urethane coating thickness is a minimum 0.002"
- Specialized corrosion resistant coating provided on threads
- Fittings are supplied with plastic encapsulated stainless steel screws
- Sizes available are ½" to 4"
- 3½" and 4" in PVC Coated Aluminum Mark 9 only

Applications:

Allied Tube & Conduit® offers the full line of Form 8 PVC Coated Conduit Bodies. All fittings are supplied with PVC coated cast iron covers. The sleeved threaded ends offer complete protection against corrosion while maintaining full ground continuity throughout the installed system.



Standards:

- UL Listed Standard 514B
- CSA Standard: C22.2 No. 18
- Verified NEMA 4X Rated

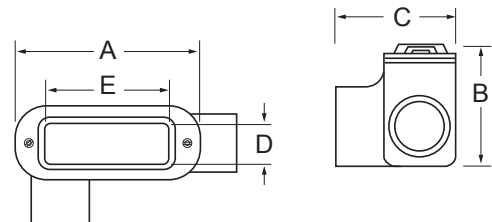

Part Number	Trade Size (in)	Metric Size (mm)	A (in)	B (in)	C (in)	D (in)	E (in)	Weight / 100 (lbs)
PV0500LR18	½	16	5.48	1.48	2.20	1.00	3.31	140
PV0700LR28	¾	21	6.35	1.73	2.35	1.19	3.94	210
PV1000LR38	1	27	7.51	1.98	2.67	1.38	4.56	260
PV1200LR48	1¼	35	8.82	2.42	3.20	1.75	5.31	450
PV1500LR58	1½	41	10.67	2.82	4.04	2.13	6.50	620
PV2000LR68	2	53	13.04	3.60	5.04	3.00	8.56	1070
PV2500LR78	2½	63	15.98	4.48	6.73	4.25	10.88	1770
PV3000LR88	3	78	15.98	4.85	6.73	4.25	10.88	1800
PA3500LR989	3½	91	14.73	4.92	6.98	4.50	10.25	2100
PA4000LR1089	4	103	14.73	5.42	6.98	4.50	10.25	2400

All dimensions are for informational purposes only *Tolerances +/- 5%



For more info visit alliedeg.us