

Polypropylene Metal Detectable Cable Ties and Mounts

Polypropylene metal detectable cable ties and mounts are designed to help the food, beverage, and pharmaceutical industries meet product manufacturing safety standards. Featuring metal impregnated material, these products are identifiable by metal detection equipment. Metal detectable products from Panduit help companies comply with the U.S. Food and Drug Administration HACCP* standards and the European Union (EU) hygiene monitoring regulations. Additionally, the distinct blue color facilitates quick visual detection. Polypropylene metal detectable cable ties and mounts provide superior resistance to harsh cleaning chemicals. The GT series of tools captures the cut-off tips of ties to help further prevent process stream contamination. Polypropylene metal detectable cable ties, cable tie mounts, and installation tools deliver a complete bundling solution to help reduce product contamination and loss.

*HACCP = Hazard Analysis and Critical Control Points – a systematic preventive approach to food and pharmaceutical safety that addresses hazards as a means of prevention rather than finished product inspection.



KEY FEATURES & BENEFITS

CABLE TIES AND MOUNTS

Metal impregnated material: Allows a cable tie or cable tie mount to be identified by metal detectors helping to reduce contamination in finished products
Contributes to compliance of manufacturing standards and HACCP regulations to demonstrate due diligence for consumer safety and quality inspections

Polypropylene material: Suitable for use in a variety of environments, including areas subjected to harsh cleaning solvents providing long term durability (see material properties chart on page 2)

Blue color: Distinct color per common industry practices provides easy identification on conveyor belts and in finished products, reducing waste due to product contamination

CABLE TIES

One-piece cable tie design with locking wedge: Provides low thread force for easy and reliable installation which improves productivity and reduces the potential for operator fatigue

Curved tip: Easy to pick up tie from flat surfaces; allows faster initial threading

Smooth, round edges: Safe and easy for installers to use, won't damage cable

MOUNTS

Cradle design mount: Holds cables securely in place; provides maximum stability for cable bundle

Low profile design mount: Keeps bundle close to mounting surface and conserves space

Polypropylene Metal Detectable Cable Ties and Mounts

ORDERING INFORMATION

Polypropylene Metal Detectable Products

- For use in processing and packaging areas where aggressive acid and alkaline chemicals are used to clean the equipment
- Excellent chemical resistant cable tie and mount solution for food and pharmaceutical processing equipment manufacturing applications



Cable Ties

Part Number	Length in. (mm)	Width in. (mm)	Thickness in. (mm)	Head Height in. (mm)	Head Width in. (mm)	Max Bundle Diameter in. (mm)	Min. Loop Tensile Strength lbs. (N)	Recommended Tools	Std. Pkg. Qty.
MINIATURE CROSS SECTION									
PLT1M-C186	3.9 (100)	0.098 (2.5)	0.044 (1.1)	0.186 (4.8)	0.188 (4.8)	0.87 (22)	15 (67)	GTS-E, GS2B-E	100
INTERMEDIATE CROSS SECTION									
PLT2I-C186	8.0 (203)	0.135 (3.4)	0.047 (1.2)	0.180 (4.6)	0.240 (6.1)	2.00 (51)	18 (80)	GTS-E, GS2B-E	100
STANDARD CROSS SECTION									
PLT2S-C186	7.3 (186)	0.190 (4.8)	0.057 (1.4)	0.240 (6.1)	0.320 (8.1)	1.85 (47)	30 (133)	GTS-E, GS2B-E, GTH-E, GS4H-E	100
PLT3S-C186	11.5 (291)					3.00 (76)			
PLT4S-C186	14.4 (366)					4.00 (102)			
LIGHT-HEAVY CROSS SECTION (STRAIGHT TIP)									
PLT3H-L186	11.1 (282)	0.300 (7.6)	0.075 (1.9)	0.360 (9.1)	0.480 (12.2)	3.00 (76)	60 (267)	GTH-E, GS4H-E	50
PLT4H-L186	14.4 (366)					4.00 (102)			

Cable Tie Mounts

Part Number	Used with Cable Ties	A Width in. (mm)	B Length in. (mm)	C Height in. (mm)	Counterbore Diameter in. (mm)	Mounting Method	Std. Pkg. Qty.
TM2S8-C186	Min., Int., Std.	0.630 (16.0)	0.422 (10.7)	0.275 (7.0)	0.325 (8.3)	#8 (M4) screw	100
TM3S8-C186	Std., Lt. Hvy.	0.867 (22.0)	0.614 (15.6)	0.373 (9.5)			
TM3S10-C186					0.385 (9.8)	#10 (M5) screw	

*Order number of pieces required in multiples of standard package quantity.

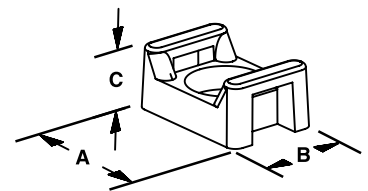

Technical Information Chart

Material Properties	Polypropylene
Max. continuous use temperature per test Method UL 746B	239°F (115°C)
Tensile strength	Moderate**
Water absorption (24 hours) per ASTM D570	0.1% (resists water absorption)
Chemical resistance	
Inorganic and organic acids	Excellent
Alkaline cleaners	Excellent
Disinfectants and sanitizers	Excellent
Color	Dark Blue

Note: Polypropylene material is recommended for use with strong alkaline and acid based cleaners that are used in high concentrations and where extended cleaning soak times are the norm. In applications where temperatures run over 239°F (115°C), stainless steel ties and mounts are recommended (see back page).

Polypropylene Metal Detectable Cable Ties and Mounts

CABLE TIE INSTALLATION TOOLS

Polypropylene metal detectable cable ties can be installed using Panduit GT series of ergonomic hand tools that capture cut-off tips of the ties during installation to help prevent product contamination. Panduit cable tie installation tools provide consistent results and speed installation to reduce installed cost.

Additional Benefits:

- Flush tie cut-off eliminates sharp edges and improves worker safety
- Lightweight, ergonomic, comfortable and easy to use



GTS-E

Installs PLT1M, PLT2I, PLT2S, PLT3S, PLT4S cable ties



GTH-E

Installs PLT2S, PLT3S, PLT4S, PLT3H, PLT4H cable ties



GS2B-E

Installs PLT1M, PLT2I, PLT2S, PLT3S, PLT4S cable ties



GS4H-E

Installs PLT2S, PLT3S, PLT4S, PLT3H, PLT4H cable ties

RELATED PRODUCTS

Stainless Steel Cable Ties and Mounts

When strength, vibration, corrosion and temperature extremes are a factor, Pan-Steel® stainless steel cable ties and mounts provide a strong, reliable system for cable bundling and mechanical fastening applications in harsh environments.

- Available in 304 and 316 grade stainless steel
- Cable tie loop tensile strength up to 1,200 lbs.
- Continuous working temperatures up to 1000°F (538°C)



QUALITY ASSURANCE

All cable tie and mount packages contain a quality control number for complete product traceability; each lot passes metal detection as part of final product verification.